

The Patco Group is an authorized sales and service center.

- Patco stocks all replacement parts for Better Packages, Marsh, and Phoenix brand tape dispensers.
- Patco offers free tech support over phone or email. Send any questions you may have.
- Patco repairs and restores both manual and electronic tape dispensers.
- Patco stocks new and refurbished tape dispensers — we do trade-ins as well.

**The Patco Group**  
 718-497-1527  
 info2@patcogroup.com  
 patcogroup.com

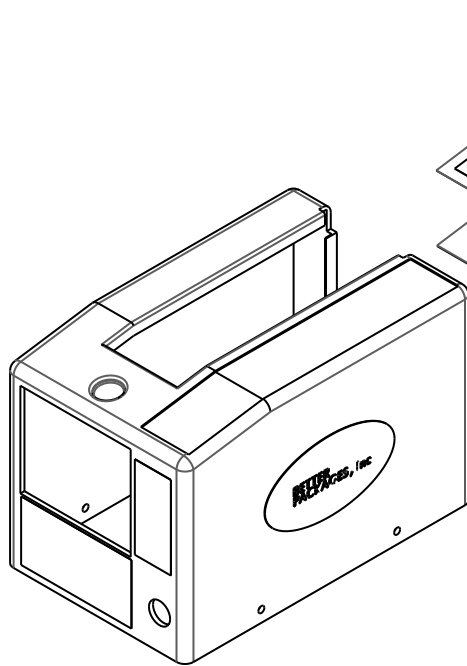

\* KEYBOARD OVERLAY

SERIAL #	PART #
1 - 1999	PS2A-102
2000 & ABOVE	PS2A-104-CE

\* KEYBOARD-LOWER BOARD

SERIAL #	PART #
1 - 1999	PS2A-103
2000 & ABOVE	PS2A-103-CE

**ITEM 1 - COVER ASSY W/ KEYBOARD**

SERIAL #	PART #
1 - 1999	PS2A-109-A
2000 & ABOVE	PS2A-109-CE

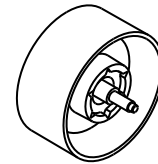

**ITEM 2 - REEL UNIT  
PS2A-107**

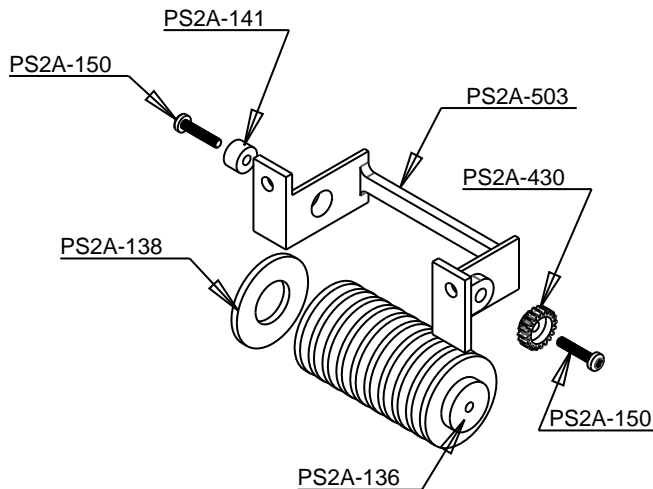

**ITEM 3 - ASSY, SEPARATING ROLLER HOLDER  
PS2A-533 - ONLY SOLD AS COMPLETE ASSEMBLY**



**ITEM 4 - PRESS ROLLER COLLAR  
PS2A-155**

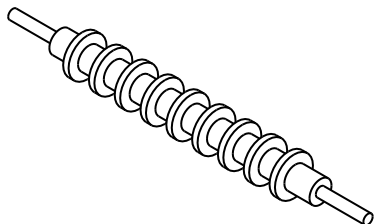

**ITEM 5 - PRESS ROLLER  
PS2A-154**

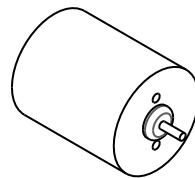

**ITEM 6 - FEED MOTOR  
PS2A-435**

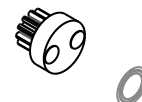

**ITEM 7 - PINION GEAR UNIT 2  
PS2A-528**

\* CE version PS2A uses parts not compatible with previous version. Select part number based on serial number printed on product ID label

**The Patco Group**  
718-497-1527  
info2@patcogroup.com  
patcogroup.com

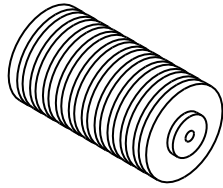

**ITEM 8 - FEED ROLLER 2**  
PS2A-312

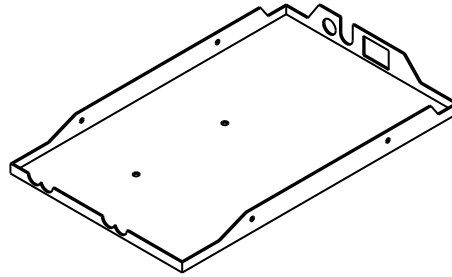

**ITEM 9 - BASE PLATE**  
PS2A-115

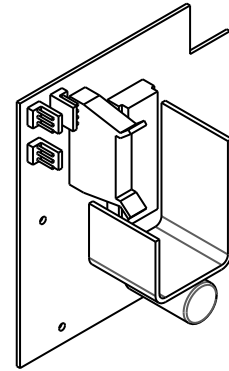

**\* ITEM 10 - PCB ASSEMBLY**

SERIAL #	PART #
1-1999	PS2A-505
2000 & ABOVE	PS2A-505-CE

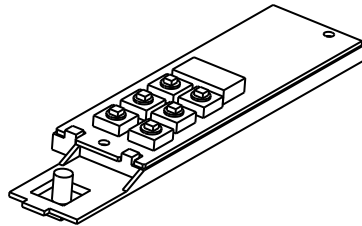

**\* ITEM 11 - DISPLAY BOARD**

SERIAL #	PART #
1-1999	PS2A-506
2000 & ABOVE	PS2A-506-CE

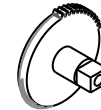

**ITEM 12 - FEED ROLLER GEAR 3**  
PS2A-427

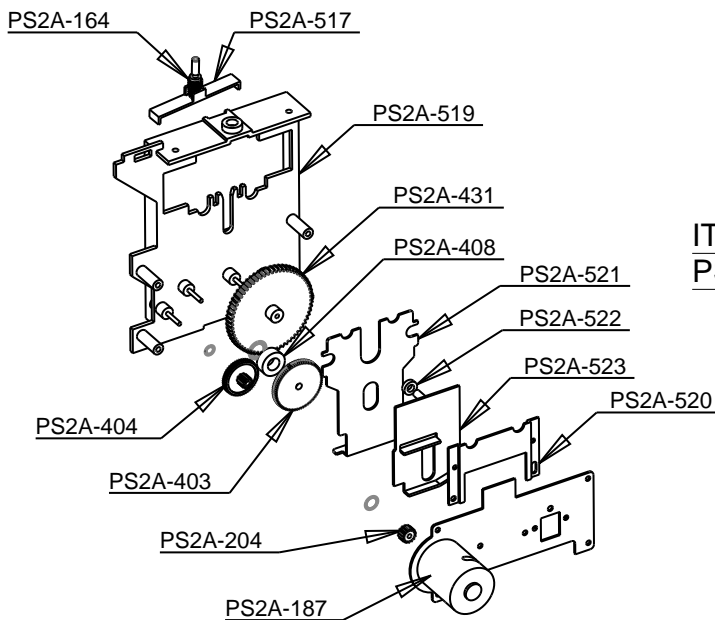

**ITEM 13 - ASSY, FRONT HOLDER**  
PS2A-518 - ONLY SOLD AS COMPLETE ASSEMBLY



**ITEM 14 - CONTROL KNOB**  
PS2A-106

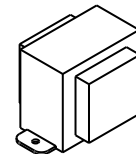

**ITEM 15 - TRANSFORMER**  
PS2A-111 (110v)  
PS2A-112 (220v-240v)

\* CE version PS2A uses parts not compatible with previous version. Select part number based on serial number printed on product ID label



**The Patco Group**  
718-497-1527  
info2@patcogroup.com  
patcogroup.com

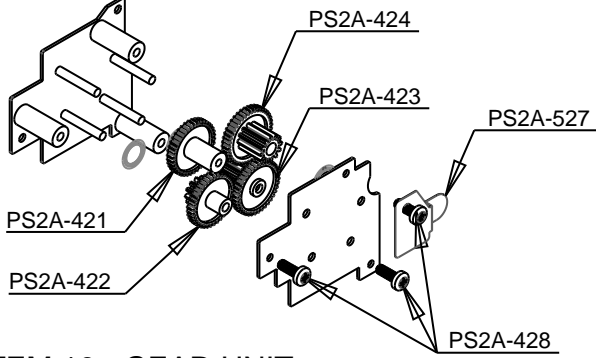

**ITEM 16 - GEAR UNIT**  
PS2A-418 - ONLY SOLD AS COMPLETE ASSEMBLY

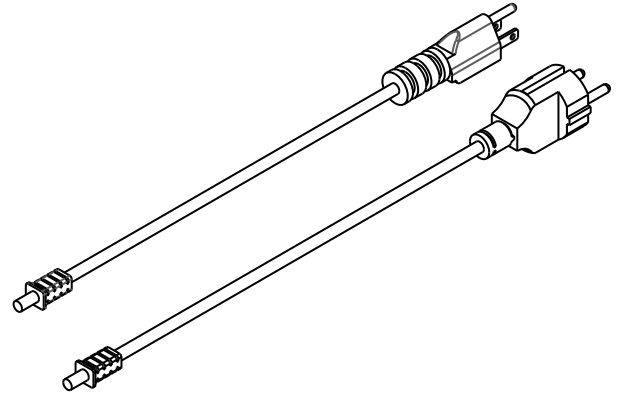

**ITEM 17 - POWER CORD WITH PLUG**  
PS2A-205-US (110v)  
PS2A-205-CE (220v-240v)

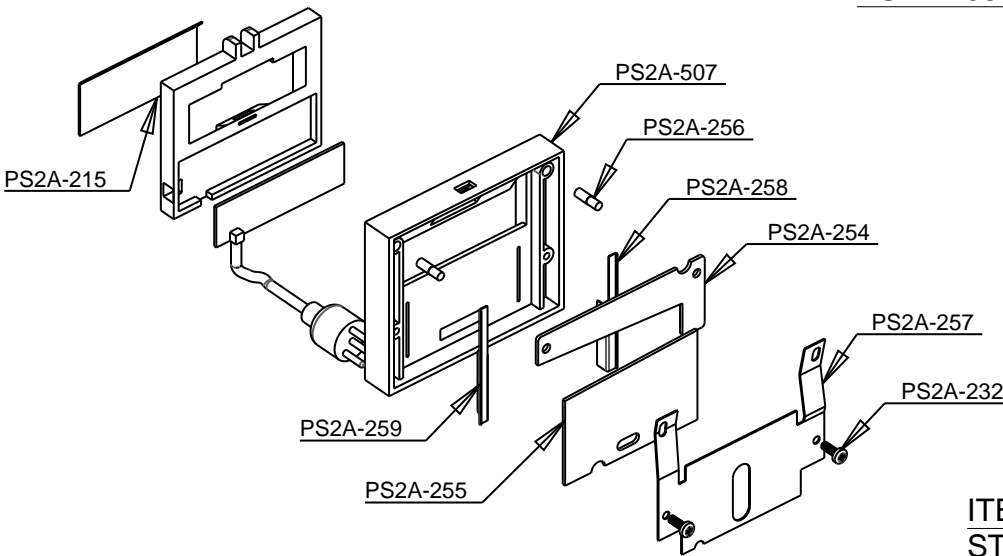

**ITEM 18 - AUTO FEED CUTTER UNIT**  
PS2A-550

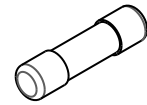

**ITEM 19 - FUSE**  
ST-2938 5x20mm 1.5A (110v)  
ST-2943 5x20mm 1A (220v-240v)

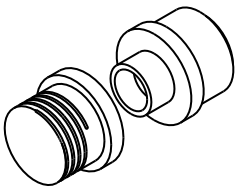

**ITEM 20 - FUSE HOLDER**  
PS2A-121

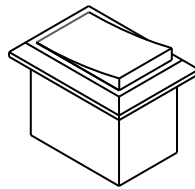

**ITEM 21 - POWER SWITCH**  
PS2A-118

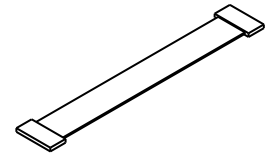

**ITEM 22 - DISPLAY BOARD CABLE**

SERIAL #	PART #
1-1999	PS2A-509
2000 & ABOVE	PS2A-509-CE

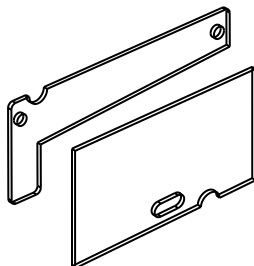

**ITEM 23 - BLADE KIT**  
PS2A-254/5